

Materials Services  
Infrastructure

# KRUPP Drifter HB60.



thyssenkrupp





# KRUPP Drifter HB60

Compact design – the ideal drifter (hammer drill) for larger drill rigs and excavator mounted drill masts.

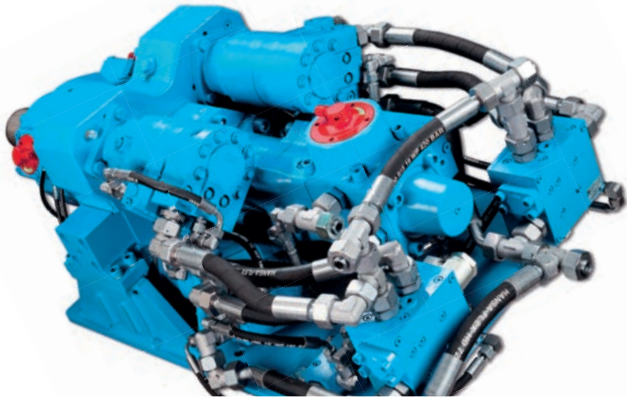

- Especially developed for overburden drilling, drive drilling, threaded self-drilling anchors and micropiles.
- Casing diameter up to 219 mm (9 inch) and threaded hollow bars up to a diameter of 127 mm (5 inch).
- The standard built-in hydraulic damping mechanism improves retraction of casings and rods and avoids blank impacts.
- Optional: electric or hydraulic changeover for the rotary drive speed and for the percussion mechanism frequency.
- Options: external flushing head, central lubrication system and integrated RPM sensor.

## Main Dimensions

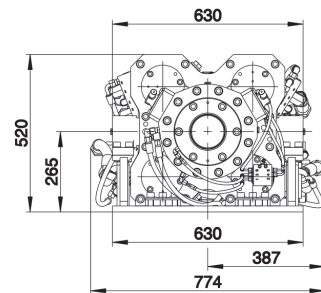
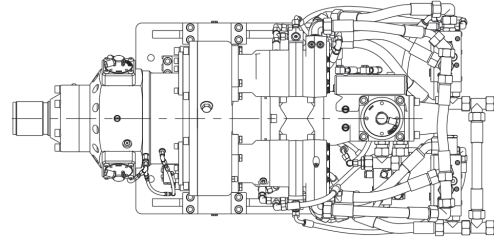
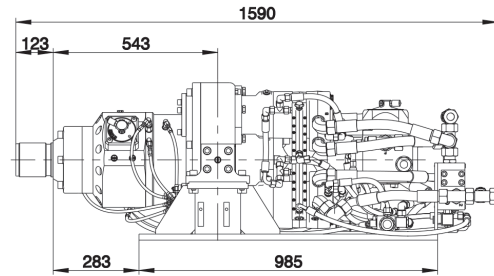

Weight approx. 980 kg  
(including base plate)

Retraction Force max. 200 kN



## Rotary Drives

| Motor-Version 2x HP480 ccm + 2x HP677 ccm |     |                            |                 |                 |                 |                 |                 |                 |                 |                 |                 |                 |                 |                 |                 |                 |                 |              |
|---|-----|----------------------------|-----------------|-----------------|-----------------|-----------------|-----------------|-----------------|-----------------|-----------------|-----------------|-----------------|-----------------|-----------------|-----------------|-----------------|-----------------|--------------|
| Pressure at rotary drive                  |     | 170 bar                    |                 |                 |                 | 200 bar         |                 |                 |                 | 240 bar         |                 |                 |                 | 280 bar         |                 |                 |                 |              |
| Gear                                      |     | 4 <sup>th</sup>            | 3 <sup>rd</sup> | 2 <sup>nd</sup> | 1 <sup>st</sup> | 4 <sup>th</sup> | 3 <sup>rd</sup> | 2 <sup>nd</sup> | 1 <sup>st</sup> | 4 <sup>th</sup> | 3 <sup>rd</sup> | 2 <sup>nd</sup> | 1 <sup>st</sup> | 4 <sup>th</sup> | 3 <sup>rd</sup> | 2 <sup>nd</sup> | 1 <sup>st</sup> |              |
| Oil flow rate (lpm)                       | 150 | Torque (Nm)<br>Speed (rpm) | 6,100<br>60     | 9,200<br>40     | 12,200<br>30    | 18,400<br>18    | 7,400<br>60     | 11,100<br>40    | 14,800<br>30    | 22,200<br>18    | 8,600<br>60     | 13,000<br>40    | 17,300<br>30    | 25,900<br>18    | 10,100<br>60    | 15,100<br>40    | 20,200<br>30    | 30,300<br>18 |
|   | 240 | Torque (Nm)<br>Speed (rpm) | 6,100<br>96     | 9,200<br>64     | 12,200<br>48    | 18,400<br>28    | 7,400<br>96     | 11,100<br>64    | 14,800<br>48    | 22,200<br>28    | 8,600<br>96     | 13,000<br>64    | 17,300<br>48    | 25,900<br>28    | 10,100<br>96    | 15,100<br>64    | 20,200<br>48    | 30,300<br>28 |
|   | 340 | Torque (Nm)<br>Speed (rpm) | 6,100<br>136    | 9,200<br>91     | 12,200<br>68    | 18,400<br>40    | 7,400<br>136    | 11,100<br>91    | 14,800<br>68    | 22,200<br>40    | 8,600<br>136    | 13,000<br>91    | 17,300<br>68    | 25,900<br>40    | 10,100<br>136   | 15,100<br>91    | 20,200<br>68    | 30,300<br>40 |

1<sup>st</sup> gear (parallel mode), 2<sup>nd</sup> gear (parallel + 2-speed mode), 3<sup>rd</sup> gear (serial mode), 4<sup>th</sup> gear (serial + 2-speed mode)

| Motor-Version 4x HP677 ccm (standard) |     |                            |                 |                 |                 |                 |                 |                 |                 |                 |                 |                 |                 |                 |                 |                 |                 |              |
|---------------------------------------|-----|----------------------------|-----------------|-----------------|-----------------|-----------------|-----------------|-----------------|-----------------|-----------------|-----------------|-----------------|-----------------|-----------------|-----------------|-----------------|-----------------|--------------|
| Pressure at rotary drive              |     | 170 bar                    |                 |                 |                 | 200 bar         |                 |                 |                 | 240 bar         |                 |                 |                 | 280 bar         |                 |                 |                 |              |
| Gear                                  |     | 4 <sup>th</sup>            | 3 <sup>rd</sup> | 2 <sup>nd</sup> | 1 <sup>st</sup> | 4 <sup>th</sup> | 3 <sup>rd</sup> | 2 <sup>nd</sup> | 1 <sup>st</sup> | 4 <sup>th</sup> | 3 <sup>rd</sup> | 2 <sup>nd</sup> | 1 <sup>st</sup> | 4 <sup>th</sup> | 3 <sup>rd</sup> | 2 <sup>nd</sup> | 1 <sup>st</sup> |              |
| Oil flow rate (lpm)                   | 150 | Torque (Nm)<br>Speed (rpm) | 7,200<br>51     | 10,700<br>34    | 14,300<br>26    | 21,500<br>15    | 8,600<br>51     | 13,000<br>34    | 17,300<br>26    | 25,900<br>15    | 10,100<br>51    | 15,200<br>34    | 20,200<br>26    | 30,400<br>15    | 11,800<br>51    | 17,700<br>34    | 23,600<br>26    | 35,400<br>15 |
|                                       | 240 | Torque (Nm)<br>Speed (rpm) | 7,200<br>82     | 10,700<br>55    | 14,300<br>41    | 21,500<br>24    | 8,600<br>82     | 13,000<br>55    | 17,300<br>41    | 25,900<br>24    | 10,100<br>82    | 15,200<br>55    | 20,200<br>41    | 30,400<br>24    | 11,800<br>82    | 17,700<br>55    | 23,600<br>41    | 35,400<br>24 |
|                                       | 340 | Torque (Nm)<br>Speed (rpm) | 7,200<br>116    | 10,700<br>77    | 14,300<br>58    | 21,500<br>34    | 8,600<br>116    | 13,000<br>77    | 17,300<br>58    | 25,900<br>34    | 10,100<br>116   | 15,200<br>77    | 20,200<br>58    | 30,400<br>34    | 11,800<br>116   | 17,700<br>77    | 23,600<br>58    | 35,400<br>34 |

1<sup>st</sup> gear (parallel mode), 2<sup>nd</sup> gear (parallel + 2-speed mode), 3<sup>rd</sup> gear (serial mode), 4<sup>th</sup> gear (serial + 2-speed mode)

| Motor-Version 2x HP677 ccm + 2x HP940 ccm |     |                            |                 |                 |                 |                 |                 |                 |                 |                 |                 |                 |                 |              |  |  |  |  |
|---|-----|----------------------------|-----------------|-----------------|-----------------|-----------------|-----------------|-----------------|-----------------|-----------------|-----------------|-----------------|-----------------|--------------|--|--|--|--|
| Pressure at rotary drive                  |     | 170 bar                    |                 |                 |                 | 200 bar         |                 |                 |                 | 240 bar         |                 |                 |                 |              |  |  |  |  |
| Gear                                      |     | 4 <sup>th</sup>            | 3 <sup>rd</sup> | 2 <sup>nd</sup> | 1 <sup>st</sup> | 4 <sup>th</sup> | 3 <sup>rd</sup> | 2 <sup>nd</sup> | 1 <sup>st</sup> | 4 <sup>th</sup> | 3 <sup>rd</sup> | 2 <sup>nd</sup> | 1 <sup>st</sup> |              |  |  |  |  |
| Oil flow rate (lpm)                       | 150 | Torque (Nm)<br>Speed (rpm) | 8,600<br>43     | 12,800<br>29    | 17,100<br>21    | 25,700<br>13    | 10,300<br>43    | 15,500<br>29    | 20,600<br>21    | 31,000<br>13    | 12,100<br>43    | 18,100<br>29    | 24,200<br>21    | 36,200<br>13 |  |  |  |  |
|   | 240 | Torque (Nm)<br>Speed (rpm) | 8,600<br>69     | 12,800<br>46    | 17,100<br>34    | 25,700<br>20    | 10,300<br>69    | 15,500<br>46    | 20,600<br>34    | 31,000<br>20    | 12,100<br>69    | 18,100<br>46    | 24,200<br>34    | 36,200<br>20 |  |  |  |  |
|   | 340 | Torque (Nm)<br>Speed (rpm) | 8,600<br>97     | 12,800<br>65    | 17,100<br>49    | 25,700<br>29    | 10,300<br>97    | 15,500<br>65    | 20,600<br>49    | 31,000<br>29    | 12,100<br>97    | 18,100<br>65    | 24,200<br>49    | 36,200<br>29 |  |  |  |  |

1<sup>st</sup> gear (parallel mode), 2<sup>nd</sup> gear (parallel + 2-speed mode), 3<sup>rd</sup> gear (serial mode), 4<sup>th</sup> gear (serial + 2-speed mode)

### Other motor versions are available

## Percussion Unit

|  |                           |
|--|---------------------------|
| Operating pressure (kp/cm <sup>2</sup> ) | 180 - 200 bar             |
| Oil flow rate (l/min)                    | 70 - 90 lpm               |
| Impact rate (min <sup>-1</sup> )         | 1,200 / 1,900 / 2,400 bpm |
| Single impact energy (Joule)             | 840 / 540 / 420 Nm        |

## Shank Adaptors (Striker Bars)

|   |                       |
|---|-----------------------|
| Male thread                                       | C112 left, C112 right |
| Other shank adaptors (striker bars) are available |                       |

Materials Services  
Infrastructure

thyssenkrupp Infrastructure GmbH  
Alte Liederbacher Str. 6  
36304 Alsfeld, Germany  
P: +49 6631 781-0  
F: +49 6631 781-113  
[machinery.tkinfrastructure@thyssenkrupp.com](mailto:machinery.tkinfrastructure@thyssenkrupp.com)  
[www.thyssenkrupp-infrastructure.com](http://www.thyssenkrupp-infrastructure.com)